

*In the Hall:  
Craft Exhibits  
Refreshments  
Quilting Demo  
Spinning Demo*

Cricket Club

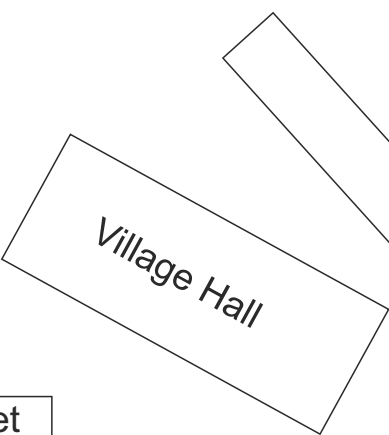

Wood

Entertainment Area



Dog Show

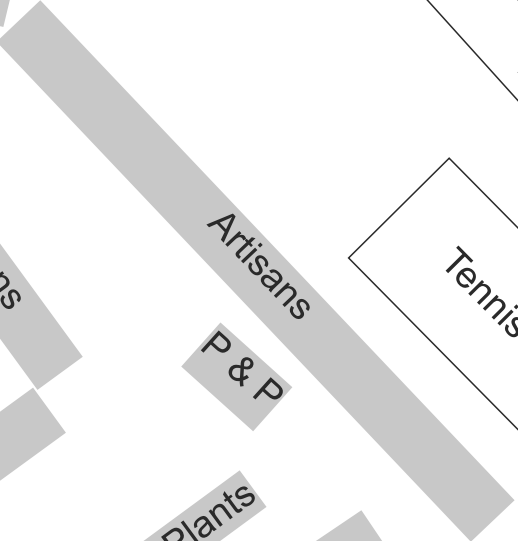
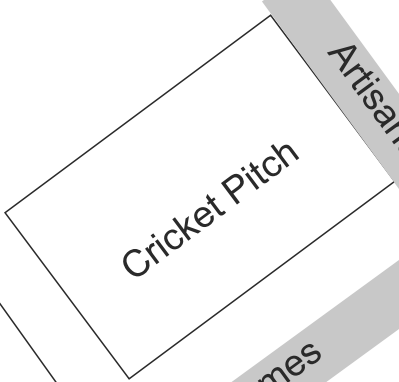
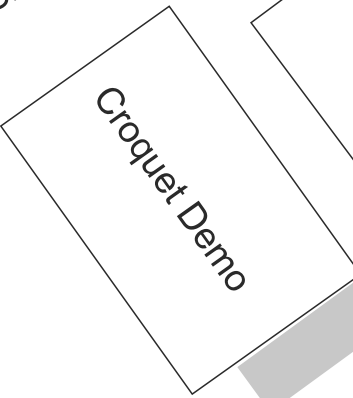

P & P

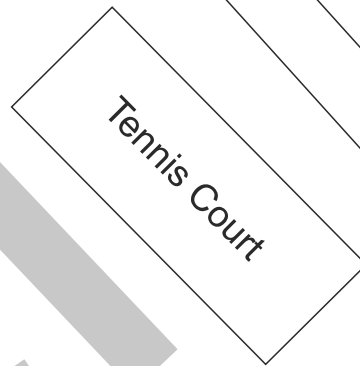

Fun & Games

SJ | Fun & Games | Plants

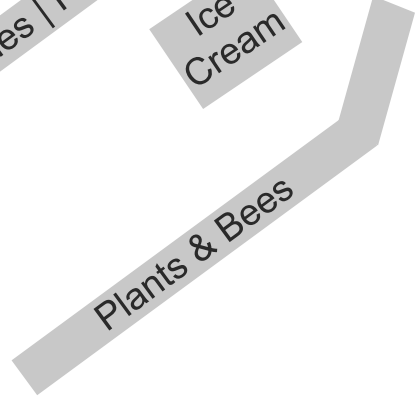
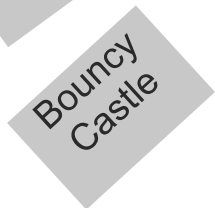

Road

*Wood = Woodwork Demo  
SJ = Strawberry Jam  
(children's entertainer)*

*P & P = Pimms  
& Prosecco*

## Exhibitors and Demonstrators

- William and Joanna Agar – vintage garden tools
- All Saints Patchwork and Quilting Group
- Axe Valley & District Conservation Society
- Bards Bees – demonstration beehive, honey, beeswax wraps
- Bee Happy Plants & Seeds – plants for pollinators
- Rosemary Bowler – plants
- CB Ceramics – porcelain buttons and coasters
- Cecilia's Sunflowers and Art – original paintings
- Charles Cheshire Plants and Gardens – unusual plants, garden design
- Coach House Cacti – cacti and succulents, pots and compost
- Coastline Soaps – handmade soaps and dog shampoo bars
- Dorset Wildlife Trust
- Flamingo Community Pool, Jubilee Project
- Lucia Hawkes – hand-made knitwear
- JK Willows – willow garden decorations
- Little Orchard Alpacas
- Maddy Locke and Joanna Schmidt – needle felting, beaded Christmas decorations
- Monty & Hobbs – hand-made bags and accessories
- Natty Deco – birchwood flowers
- Parish Petals – cut seasonal flowers
- Piccolo Plants Nursery – indoor and outdoor succulents
- RNLI
- Rotary Club of Lyme Regis
- Rousdon Spinners
- Keith Rowley – dog behaviourist
- Royal British Legion
- Samphire Jewellery – jewellery
- SusieC Phoenix Designs – cards, giftware, original arts and crafts, prints
- The Gardener's Blacksmith – plant supports and garden art
- Turn Lyme Green
- Michael Tyler – woodcrafts
- Mrs Ethelston's PTFA
- Ukraine Support – plants
- ULRHS Books
- ULRHS Food Tombola
- ULRHS Plants
- ULRHS Raffle
- Uplyme Church Raffle
- Uplyme Ladies Group
- Uplyme Village Hall
- Utility Warehouse Discount Club – utilities savings club
- Anne Walker – Craft, trains, plants
- Penny Walmsley / Barbara Dunkley – hardy perennials
- Woodroffe School Gardening Club
- Woodwork Dot Wood – woodworking demonstration